

← CORNICE UNCHANGED

EXPOSE GRANITE PIER →

← EXPOSE GRANITE LINTEL

← BOX IN STEEL BEAM WITH WOOD-MOUNT SIGN ON WOOD BOX. NOTE: ONCE FACADE IS STRIPPED, DETAILS OF ENCLOSURE WILL BE DETERMINED

← EXPOSE GRANITE PIER

← NOTE: IT WOULD BE BEST TO RESTORE WOOD BASE WITH CELLAR WINDOWS BUT BRICK MAY REMAIN.

NOTE THAT PLATE GLASS IS HISTORICAL. BUILDING ORIGINALLY HAD SECOND GLAZED WALL ON INSIDE OF DISPLAY WINDOW. FOR INCREASED INSULATION, THAT MIGHT BE RESTORED →

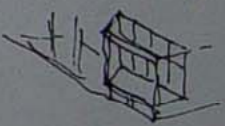

↑ REMOVE BRICK BASES FROM POSTS. SHEATH POSTS IN WOOD TRIM

↑ ORIGINAL BASE SHOWN IN DRAWING BELOW

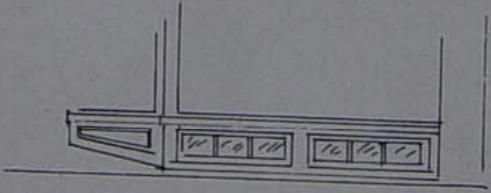

SCALE: 1/4" = 1'-0"
NOTE: ALL DIMENSIONS APPROXIMATE. CONFIRM AT SITE

6

PROPOSED REMODELING.
SMITH-WHITTIER BLOCK
DATE: 3/17/83
CHRISTOPHER GLASS, ARCHITECT
38 CHESTNUT ST. CAMDEN, MAINE 04843 207-236-8218
3/17/83